

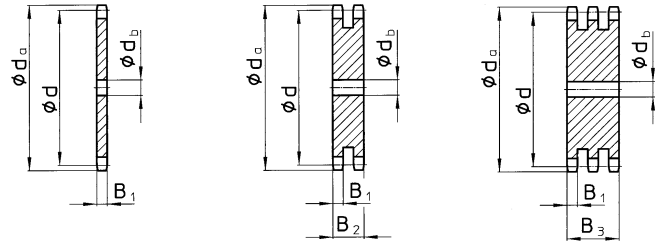

Kettenradscheiben Teilung 1/2" (12,7 mm)

für Rollenketten 1/2" × 5/16" nach DIN 8187 bzw. ISO/R 606 (08 B)



| Kettenrad | mm | Kette | mm |
|----------------|------|--------------|-------|
| B ₁ | 7,2 | Teilung | 12,70 |
| B ₂ | 21,0 | lichte Weite | 7,75 |
| B ₃ | 34,9 | Rollen-ø | 8,51 |

| Zähnezahl | 1-fach | | 2-fach | | 3-fach |
|-----------|----------------|--------|----------------|----------------|----------------|
| z | d _a | d | d _b | d _b | d _b |
| 8 | 37,0 | 33,19 | 8 | 10 | 10 |
| 9 | 41,0 | 37,13 | 8 | 10 | 10 |
| 10 | 45,0 | 41,10 | 8 | 10 | 10 |
| 11 | 49,0 | 45,08 | 10 | 10 | 12 |
| 12 | 53,0 | 49,07 | 10 | 10 | 12 |
| 13 | 57,0 | 53,07 | 10 | 10 | 12 |
| 14 | 61,5 | 57,07 | 10 | 10 | 12 |
| 15 | 65,5 | 61,08 | 10 | 10 | 12 |
| 16 | 69,5 | 65,10 | 10 | 12 | 16 |
| 17 | 73,5 | 69,12 | 10 | 12 | 16 |
| 18 | 77,5 | 73,14 | 10 | 12 | 16 |
| 19 | 81,5 | 77,16 | 10 | 12 | 16 |
| 20 | 85,5 | 81,18 | 10 | 12 | 16 |
| 21 | 89,5 | 85,21 | 12 | 16 | 16 |
| 22 | 93,5 | 89,24 | 12 | 16 | 16 |
| 23 | 98,0 | 93,27 | 12 | 16 | 16 |
| 24 | 102,0 | 97,30 | 12 | 16 | 16 |
| 25 | 106,0 | 101,33 | 12 | 16 | 16 |
| 26 | 110,0 | 105,36 | 16 | 16 | 16 |
| 27 | 114,0 | 109,40 | 16 | 16 | 16 |
| 28 | 118,0 | 113,43 | 16 | 16 | 16 |
| 29 | 122,0 | 117,46 | 16 | 16 | 16 |
| 30 | 126,0 | 121,50 | 16 | 16 | 16 |
| 31 | 130,0 | 125,53 | 16 | 16 | 20 |
| 32 | 134,0 | 129,57 | 16 | 16 | 20 |
| 33 | 138,0 | 133,61 | 16 | 16 | 20 |
| 34 | 142,0 | 137,64 | 16 | 16 | 20 |
| 35 | 146,0 | 141,68 | 16 | 16 | 20 |
| 36 | 151,0 | 145,72 | 16 | 20 | 20 |
| 37 | 154,5 | 149,75 | 16 | 20 | 20 |
| 38 | 158,5 | 153,79 | 16 | 20 | 20 |
| 39 | 162,5 | 157,83 | 16 | 20 | 20 |
| 40 | 167,0 | 161,87 | 16 | 20 | 20 |
| 41 | 171,0 | 165,91 | 20 | 20 | 25 |
| 42 | 175,0 | 169,94 | 20 | 20 | 25 |
| 43 | 179,0 | 173,98 | 20 | 20 | 25 |

| Zähnezahl | 1-fach | | 2-fach | | 3-fach |
|-----------|----------------|--------|----------------|----------------|----------------|
| z | d _a | d | d _b | d _b | d _b |
| 44 | 183,0 | 178,02 | 20 | 20 | 25 |
| 45 | 187,0 | 182,06 | 20 | 20 | 25 |
| 46 | 191,0 | 186,10 | 20 | 20 | 25 |
| 47 | 195,0 | 190,14 | 20 | 20 | 25 |
| 48 | 199,0 | 194,18 | 20 | 20 | 25 |
| 49 | 203,0 | 198,22 | 20 | 20 | 25 |
| 50 | 207,0 | 202,26 | 20 | 20 | 25 |
| 51 | 211,0 | 206,30 | 20 | 25 | 25 |
| 52 | 215,0 | 210,34 | 20 | 25 | 25 |
| 53 | 219,0 | 214,38 | 20 | 25 | 25 |
| 54 | 223,0 | 218,42 | 20 | 25 | 25 |
| 55 | 227,0 | 222,46 | 20 | 25 | 25 |
| 56 | 231,5 | 226,50 | 20 | 25 | 25 |
| 57 | 235,5 | 230,54 | 20 | 25 | 25 |
| 58 | 240,0 | 234,58 | 20 | 25 | 25 |
| 59 | 244,0 | 238,62 | 20 | 25 | 25 |
| 60 | 248,5 | 242,66 | 20 | 25 | 25 |
| 62 | 256,0 | 250,74 | 25 | 25 | 25 |
| 64 | 264,0 | 258,83 | 25 | 25 | 25 |
| 65 | 268,0 | 262,87 | 25 | 25 | 25 |
| 66 | 272,5 | 266,91 | 25 | 25 | 25 |
| 68 | 281,0 | 274,99 | 25 | 25 | 25 |
| 70 | 288,5 | 283,07 | 25 | 25 | 25 |
| 72 | 296,5 | 291,15 | 25 | 25 | 25 |
| 75 | 308,5 | 303,28 | 25 | 25 | 25 |
| 76 | 312,5 | 307,32 | 25 | 25 | 25 |
| 78 | 320,5 | 315,40 | 25 | 25 | 25 |
| 80 | 328,5 | 323,49 | 25 | 25 | 25 |
| 85 | 348,0 | 343,69 | 25 | 25 | 25 |
| 90 | 369,0 | 363,90 | 25 | 25 | 25 |
| 95 | 390,0 | 384,11 | 25 | 25 | 25 |
| 100 | 410,0 | 404,32 | 25 | 25 | 25 |
| 110 | 450,0 | 444,74 | 25 | 25 | 25 |
| 114 | 466,0 | 460,91 | 25 | 25 | 25 |
| 120 | 491,0 | 485,16 | 25 | 25 | 25 |
| 125 | 511,0 | 505,37 | 25 | 25 | 25 |

Kettenradscheiben werden aus Stahl mit einer Mindestzugfestigkeit von 490 N/mm² hergestellt.
Alle Kettenradscheiben sind mit Fertigungsbearbeitung und Nut lieferbar.

Kettenräder Teilung 1/2" (12,7 mm)



für Rollenketten 1/2" × 5/16" nach DIN 8187 bzw. ISO/R 606 (08 B)

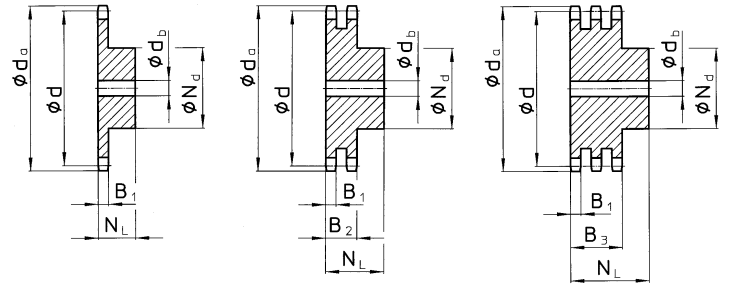

| Kettenrad | mm | Kette | mm |
|----------------|------|--------------|-------|
| B ₁ | 7,2 | Teilung | 12,70 |
| B ₂ | 21,0 | lichte Weite | 7,75 |
| B ₃ | 34,9 | Rollen-ø | 8,51 |

| Zähnezahl z | 1-fach | | | | | 2-fach | | | 3-fach | | |
|----------------|----------------|--------|----------------|----------------|----------------|----------------|----------------|----------------|----------------|----------------|----------------|
| | d _a | d | N _d | d _b | N _L | N _d | d _b | N _L | N _d | d _b | N _L |
| 8 | 37,0 | 33,19 | 20 | 10 | 25 | 20 | 10 | 32 | 20 | 10 | 46 |
| 9 | 41,0 | 37,13 | 24 | 10 | 25 | 24 | 10 | 32 | 24 | 12 | 46 |
| 10 | 45,0 | 41,10 | 26 | 10 | 25 | 28 | 10 | 32 | 28 | 12 | 46 |
| 11 | 49,0 | 45,08 | 29 | 10 | 25 | 32 | 12 | 35 | 32 | 16 | 50 |
| 12 | 53,0 | 49,07 | 33 | 10 | 28 | 35 | 12 | 35 | 35 | 16 | 50 |
| 13 | 57,0 | 53,07 | 37 | 10 | 28 | 38 | 12 | 35 | 38 | 16 | 50 |
| 14 | 61,5 | 57,07 | 41 | 10 | 28 | 42 | 12 | 35 | 42 | 16 | 50 |
| 15 | 65,5 | 61,08 | 45 | 10 | 28 | 46 | 12 | 35 | 46 | 16 | 50 |
| 16 | 69,5 | 65,10 | 50 | 12 | 28 | 50 | 14 | 35 | 50 | 16 | 50 |
| 17 | 73,5 | 69,12 | 52 | 12 | 28 | 54 | 14 | 35 | 54 | 16 | 50 |
| 18 | 77,5 | 73,14 | 56 | 12 | 28 | 58 | 14 | 35 | 58 | 16 | 50 |
| 19 | 81,5 | 77,16 | 60 | 12 | 28 | 62 | 14 | 35 | 62 | 16 | 50 |
| 20 | 85,5 | 81,18 | 64 | 12 | 28 | 66 | 14 | 35 | 66 | 16 | 50 |
| 21 | 89,5 | 85,21 | 68 | 14 | 28 | 70 | 16 | 40 | 70 | 20 | 55 |
| 22 | 93,5 | 89,24 | 70 | 14 | 28 | 70 | 16 | 40 | 70 | 20 | 55 |
| 23 | 98,0 | 93,27 | 70 | 14 | 28 | 70 | 16 | 40 | 70 | 20 | 55 |
| 24 | 102,0 | 97,30 | 70 | 14 | 28 | 75 | 16 | 40 | 75 | 20 | 55 |
| 25 | 106,0 | 101,33 | 70 | 14 | 28 | 80 | 16 | 40 | 80 | 20 | 55 |
| 26 | 110,0 | 105,36 | 70 | 16 | 30 | 85 | 20 | 40 | 85 | 20 | 55 |
| 27 | 114,0 | 109,40 | 70 | 16 | 30 | 85 | 20 | 40 | 85 | 20 | 55 |
| 28 | 118,0 | 113,43 | 70 | 16 | 30 | 90 | 20 | 40 | 90 | 20 | 55 |
| 29 | 122,0 | 117,46 | 80 | 16 | 30 | 95 | 20 | 40 | 95 | 20 | 55 |
| 30 | 126,0 | 121,50 | 80 | 16 | 30 | 100 | 20 | 40 | 100 | 20 | 55 |
| 31 | 130,0 | 125,53 | 90 | 16 | 30 | 100 | 20 | 40 | 110 | 20 | 55 |
| 32 | 134,0 | 129,57 | 90 | 16 | 30 | 100 | 20 | 40 | 110 | 20 | 55 |
| 33 | 138,0 | 133,61 | 90 | 16 | 30 | 100 | 20 | 40 | 110 | 20 | 55 |
| 34 | 142,0 | 137,64 | 90 | 16 | 30 | 100 | 20 | 40 | 110 | 20 | 55 |
| 35 | 146,0 | 141,68 | 90 | 16 | 30 | 100 | 20 | 40 | 110 | 20 | 55 |
| 36 | 151,0 | 145,72 | 90 | 16 | 35 | 110 | 20 | 40 | 120 | 25 | 55 |
| 37 | 154,5 | 149,75 | 90 | 16 | 35 | 110 | 20 | 40 | 120 | 25 | 55 |
| 38 | 158,5 | 153,79 | 90 | 16 | 35 | 110 | 20 | 40 | 120 | 25 | 55 |
| 39 | 162,5 | 157,83 | 90 | 16 | 35 | 110 | 20 | 40 | 120 | 25 | 55 |
| 40 | 167,0 | 161,87 | 90 | 16 | 35 | 110 | 20 | 40 | 120 | 25 | 55 |

Kettenräder werden aus Stahl mit einer Mindestzugfestigkeit von 490 N/mm² hergestellt.

Alle Kettenräder sind mit Fertigbohrung und Nut lieferbar.

Kettenräder mit hier nicht aufgeführten Teilungen und/oder Abmessungen fertigen wir nach Kundenwunsch.