

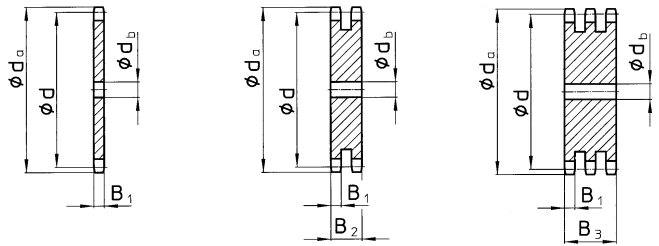

Kettenradscheiben Teilung 1 1/2" (38,1 mm)

für Rollenketten 1 1/2" × 1" nach DIN 8187 bzw. ISO/R 606 (24 B)



| Kettenrad | mm | Kette | mm |
|----------------|-------|--------------|------|
| B ₁ | 24,1 | Teilung | 38,1 |
| B ₂ | 72,0 | lichte Weite | 25,4 |
| B ₃ | 120,3 | Rollen-ø | 25,4 |

| Zähnezahl | | 1-fach | 2-fach | 3-fach |
|-----------|----------------|--------|----------------|----------------|
| z | d _a | d | d _b | d _b |
| 8 | 109 | 99,56 | 20 | 25 |
| 9 | 122 | 111,40 | 20 | 25 |
| 10 | 134 | 123,29 | 20 | 25 |
| 11 | 147 | 135,23 | 25 | 30 |
| 12 | 159 | 147,21 | 25 | 30 |
| 13 | 172 | 159,20 | 25 | 30 |
| 14 | 184 | 171,22 | 25 | 30 |
| 15 | 196 | 183,25 | 25 | 30 |
| 16 | 209 | 195,29 | 25 | 30 |
| 17 | 221 | 207,35 | 25 | 30 |
| 18 | 233 | 219,41 | 25 | 30 |
| 19 | 245 | 231,48 | 25 | 30 |
| 20 | 258 | 243,55 | 25 | 30 |
| 21 | 270 | 255,63 | 30 | 40 |
| 22 | 282 | 267,72 | 30 | 40 |
| 23 | 294 | 279,80 | 30 | 40 |
| 24 | 307 | 291,90 | 30 | 40 |
| 25 | 319 | 303,99 | 30 | 40 |
| 26 | 331 | 316,09 | 30 | 40 |
| 27 | 343 | 328,19 | 30 | 40 |
| 28 | 355 | 340,29 | 30 | 40 |
| 29 | 367 | 352,39 | 30 | 40 |
| 30 | 380 | 364,49 | 30 | 40 |
| 31 | 392 | 376,60 | 30 | 40 |
| 32 | 404 | 388,71 | 30 | 40 |
| 33 | 416 | 400,82 | 30 | 40 |
| 34 | 428 | 412,93 | 30 | 40 |
| 35 | 440 | 425,04 | 30 | 40 |
| 36 | 453 | 437,15 | 30 | 40 |
| 37 | 465 | 449,26 | 30 | 40 |
| 38 | 477 | 461,37 | 30 | 40 |
| 39 | 489 | 473,49 | 30 | 40 |
| 40 | 501 | 485,60 | 30 | 40 |
| 41 | 513 | 497,72 | 30 | 40 |
| 42 | 526 | 509,83 | 30 | 40 |
| 43 | 538 | 521,95 | 30 | 40 |

| Zähnezahl | | 1-fach | 2-fach | 3-fach |
|-----------|----------------|---------|----------------|----------------|
| z | d _a | d | d _b | d _b |
| 44 | 550 | 534,07 | 30 | 40 |
| 45 | 562 | 546,19 | 30 | 40 |
| 46 | 574 | 558,30 | 30 | 40 |
| 47 | 586 | 570,42 | 30 | 40 |
| 48 | 598 | 582,54 | 30 | 40 |
| 49 | 611 | 594,66 | 30 | 40 |
| 50 | 623 | 606,78 | 30 | 40 |
| 51 | 635 | 618,90 | 30 | 40 |
| 52 | 647 | 631,02 | 30 | 40 |
| 53 | 659 | 643,14 | 30 | 40 |
| 54 | 671 | 655,26 | 30 | 40 |
| 55 | 683 | 667,38 | 30 | 40 |
| 56 | 696 | 679,50 | 30 | 40 |
| 57 | 708 | 691,62 | 30 | 40 |
| 58 | 720 | 703,75 | 30 | 40 |
| 59 | 732 | 715,87 | 30 | 40 |
| 60 | 744 | 727,99 | 30 | 40 |
| 62 | 768 | 752,23 | 40 | 40 |
| 64 | 793 | 776,48 | 40 | 40 |
| 65 | 805 | 788,60 | 40 | 40 |
| 66 | 817 | 800,72 | 40 | 40 |
| 68 | 841 | 824,97 | 40 | 40 |
| 70 | 866 | 849,22 | 40 | 40 |
| 72 | 890 | 873,46 | 40 | 40 |
| 75 | 926 | 909,84 | 40 | 40 |
| 76 | 938 | 921,96 | 40 | 40 |
| 80 | 987 | 970,46 | 40 | 40 |
| 85 | 1048 | 1031,08 | 40 | 40 |
| 95 | 1169 | 1152,33 | 40 | 40 |

Kettenradscheiben werden aus Stahl mit einer Mindestzugfestigkeit von 490 N/mm² hergestellt.
Alle Kettenradscheiben sind mit Fertigbohrung und Nut lieferbar.

Kettenräder Teilung 1 1/2" (38,1 mm)



für Rollenketten 1 1/2" × 1" nach DIN 8187 bzw. ISO/R 606 (24 B)

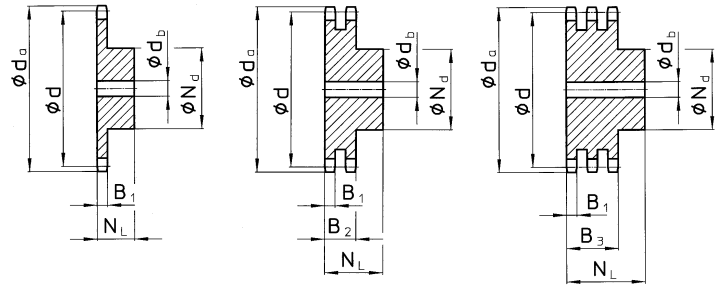

| Kettenrad | mm | Kette | mm |
|-----------|-------|----------------|------|
| B_1 | 24,1 | Teilung | 38,1 |
| B_2 | 72,0 | lichte Weite | 25,4 |
| B_3 | 120,3 | Rollen- ϕ | 25,4 |

| Zähnezahl z | 1-fach | | | | | 2-fach | | | 3-fach | | |
|----------------|--------|--------|-------|-------|-------|--------|-------|-------|--------|-------|-------|
| | d_a | d | N_d | d_b | N_L | N_d | d_b | N_L | N_d | d_b | N_L |
| 8 | 109 | 99,56 | 58 | 20 | 45 | 58 | 25 | 95 | 58 | 25 | 140 |
| 9 | 122 | 111,40 | 70 | 20 | 45 | 70 | 25 | 95 | 70 | 25 | 140 |
| 10 | 134 | 123,29 | 80 | 20 | 45 | 80 | 25 | 95 | 80 | 25 | 140 |
| 11 | 147 | 135,23 | 90 | 25 | 50 | 90 | 25 | 100 | 90 | 30 | 150 |
| 12 | 159 | 147,21 | 102 | 25 | 50 | 102 | 25 | 100 | 102 | 30 | 150 |
| 13 | 172 | 159,20 | 114 | 25 | 50 | 114 | 25 | 100 | 114 | 30 | 150 |
| 14 | 184 | 171,22 | 128 | 25 | 50 | 128 | 25 | 100 | 128 | 30 | 150 |
| 15 | 196 | 183,25 | 140 | 25 | 50 | 140 | 25 | 100 | 140 | 30 | 150 |
| 16 | 209 | 195,29 | 140 | 25 | 55 | 140 | 30 | 100 | 140 | 30 | 150 |
| 17 | 221 | 207,35 | 140 | 25 | 55 | 150 | 30 | 100 | 150 | 30 | 150 |
| 18 | 233 | 219,41 | 140 | 25 | 55 | 160 | 30 | 100 | 160 | 30 | 150 |
| 19 | 245 | 231,48 | 140 | 25 | 55 | 160 | 30 | 100 | 160 | 30 | 150 |
| 20 | 258 | 243,55 | 140 | 25 | 55 | 160 | 30 | 100 | 160 | 30 | 150 |
| 21 | 270 | 255,63 | 150 | 30 | 60 | 160 | 30 | 100 | 160 | 40 | 150 |
| 22 | 282 | 267,72 | 150 | 30 | 60 | 160 | 30 | 100 | 160 | 40 | 150 |
| 23 | 294 | 279,80 | 150 | 30 | 60 | 160 | 30 | 100 | 160 | 40 | 150 |
| 24 | 307 | 291,90 | 150 | 30 | 60 | 160 | 30 | 100 | 160 | 40 | 150 |
| 25 | 319 | 303,99 | 150 | 30 | 60 | 160 | 30 | 100 | 160 | 40 | 150 |
| 26 | 331 | 316,09 | 160 | 30 | 60 | 160 | 30 | 100 | 160 | 40 | 150 |
| 27 | 343 | 328,19 | 160 | 30 | 60 | 160 | 30 | 100 | 160 | 40 | 150 |
| 28 | 355 | 340,29 | 160 | 30 | 60 | 160 | 30 | 100 | 160 | 40 | 150 |
| 29 | 367 | 352,39 | 160 | 30 | 60 | 160 | 30 | 100 | 160 | 40 | 150 |
| 30 | 380 | 364,49 | 160 | 30 | 60 | 160 | 30 | 100 | 160 | 40 | 150 |
| 31 | 392 | 376,60 | 160 | 30 | 60 | 160 | 40 | 100 | 160 | 40 | 150 |
| 32 | 404 | 388,71 | 160 | 30 | 60 | 160 | 40 | 100 | 160 | 40 | 150 |
| 33 | 416 | 400,82 | 160 | 30 | 60 | 160 | 40 | 100 | 160 | 40 | 150 |
| 34 | 428 | 412,93 | 160 | 30 | 60 | 160 | 40 | 100 | 160 | 40 | 150 |
| 35 | 440 | 425,04 | 160 | 30 | 60 | 160 | 40 | 100 | 160 | 40 | 150 |
| 36 | 453 | 437,15 | 160 | 30 | 60 | 160 | 40 | 100 | 160 | 40 | 150 |
| 37 | 465 | 449,26 | 160 | 30 | 60 | 160 | 40 | 100 | 160 | 40 | 150 |
| 38 | 477 | 461,37 | 160 | 30 | 60 | 160 | 40 | 100 | 160 | 40 | 150 |
| 39 | 489 | 473,49 | 160 | 30 | 60 | 160 | 40 | 100 | 160 | 40 | 150 |
| 40 | 501 | 485,60 | 160 | 30 | 60 | 160 | 40 | 100 | 160 | 40 | 150 |

Kettenräder werden aus Stahl mit einer Mindestzugfestigkeit von 490 N/mm² hergestellt.

Alle Kettenräder sind mit Fertigbohrung und Nut lieferbar.

Kettenräder mit hier nicht aufgeführten Teilungen und/oder Abmessungen fertigen wir nach Kundenwunsch.